

Suggestion for a New Alternative for the Tribal Trail Connector Road

As members of the Tribal Trail Connector Road stakeholders committee, we have attended meetings, listened to concerns, and considered alternatives. We have been impressed by the leadership of the county engineer's team and their knowledge, professionalism, and willingness to personally sacrifice time and energy in the interests of an open and transparent process.

We request that an alternative 14 or N- 2B be created for our November 15th, 2019 meeting. This new alternative continues the planning process but puts on hold the intersection at 22 and the last unbuilt 1,800' of Tribal Trail Rd. We are not saying "never", we are saying "not now". This project should be revisited when WYDOT, Teton County, and the town of Jackson have finalized plans for all of WY22, 390 and its intersection with US89, the north bridge, and wildlife connectivity.

"This alternative reflects certain items to we believe should proceed now."

1. A new intersection at Indian Springs Drive and Coyote Canyon Road with an underpass providing an alternative to left turns onto WY22 for Teton Science Schools, Indian Springs Ranch. A public/ private partnership with Indian Springs HOA and the (TSS) Mt. Academy should be pursued.
2. A new roundabout at the intersection of South Park Loop, Boyles Hill Road, and Tribal Trail Road with an emphasis on pedestrian and bicycle safety.
3. A new multi-use pathway on the west side of existing Tribal Trail Road or six feet wide colored bike lanes on both sides of Tribal Trail Road for summer use only.
4. Calming features on Tribal Trail Road at the intersections with Seneca, Lakota, and Cherokee Lanes.
5. A weight limit on the Tribal Trail Road with the exception of public and school buses and no through truck traffic.
6. Upgrade to the existing bicycle path between Cherokee Lane and HWY 22 to make it sufficient for one-way traffic by emergency vehicles.
7. A conceptualization for landscaping and public art along Tribal Trail Road and the upgraded bicycle path.

Dave Schofield
Tom Holland
Ralph Haberfeld/ Mike Halpin
Frank Lane
Alex Muromcew
Lisa Carpenter
Carrie Geraci

From: Frank Lane <flane@wyoming.com>
Sent: Friday, September 27, 2019 4:18 PM
To: mike@halpinmail.com
Cc: Amy Ramage <aramage@tetoncountywy.gov>; Heather Overholser <hoverholser@tetoncountywy.gov>
Subject: Tribal Trail

[NOTICE: This message originated outside of the Teton County's mail system -- DO NOT CLICK on links or open attachments unless you are sure the content is safe.]

Mike, Amy and Heather,

I wanted to run something by you all before I bring it up to the entire Tribal Trail group. This idea came up during discussions with some neighbors and the crew that frequents the “geriatric corner” of the Brew Pub.

Many of the Teton County residents I have had discussions with are concerned about the increase in traffic through the neighborhoods in close proximity to Tribal Trail Road and this leads to their apprehension to support the road expansion. I am hearing from many residents that there are fears that the expansion of Tribal Trail Road will just be the “opening of the flood gates” and the completion of the road would lead to other new roads to be built or existing roads widened once TTR is completed. I am also hearing from many residents that they feel that emergency access/redundancy is needed and the question posed to me by many is how can we satisfy the need for emergency response and

access without building out Tribal Trail Road.

So that got me thinking – how can we enhance emergency response without building the road? Well – here is my idea...Can we build a dirt/gravel road that could be gated at the existing “end” of Tribal Trail Road and also at a new highway 22 access point? Emergency response vehicles could unlock the gates via some sort of automatic signal when needed. The gravel road could also serve during weather, accidents or any other incident that would require diverting traffic through the road when needed – on a temporary basis.

I would think that a simple right turn only exit could be built on Highway 22 to access the gravel road. Emergency vehicles responding from the west bank could simply drive through the “Y” to get back home.

Lots to be discusses and schussed out – but I think it is an idea that should be considered. If, at a later date, traffic volumes force the completion of the Tribal Trail Road – the road base would already be there.

Thanks for your time – feel free to respond to this email or we can discuss at next week’s meeting with the whole group.

Best,
Frank

Frank Lane
PO Box 4333
Jackson, WY 83001



Correspondence, including e-mail, to and from employees of Teton County, in connection with the transaction of public business, is subject to the Wyoming Public Records Act and may be disclosed to third parties.

Draft

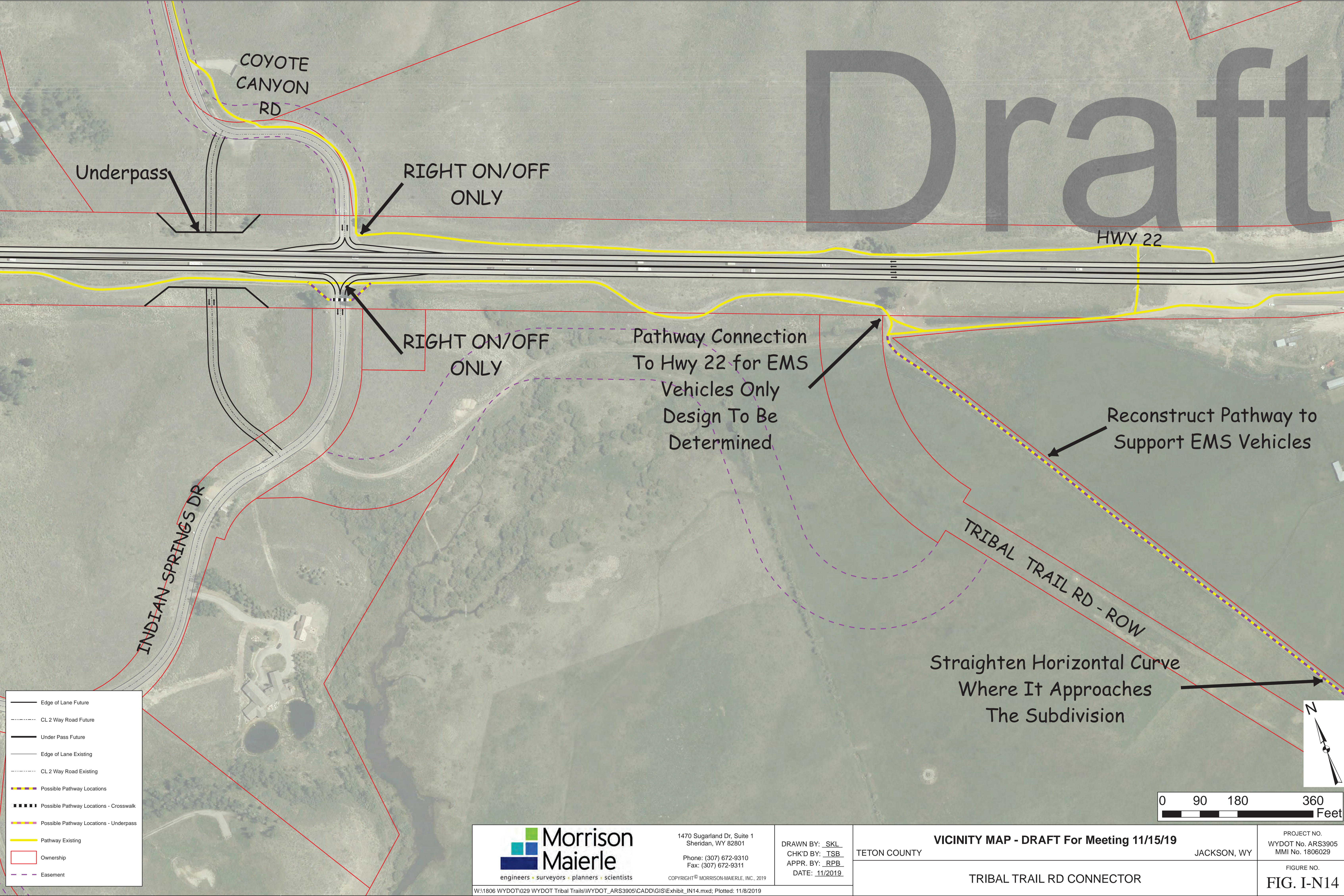

- Edge of Lane Future
- CL 2 Way Road Future
- Under Pass Future
- Edge of Lane Existing
- CL 2 Way Road Existing
- Possible Pathway Locations
- Possible Pathway Locations - Crosswalk
- Possible Pathway Locations - Underpass
- Pathway Existing
- Ownership
- Easement

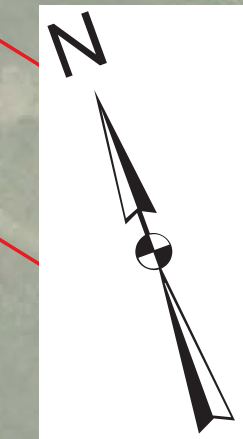
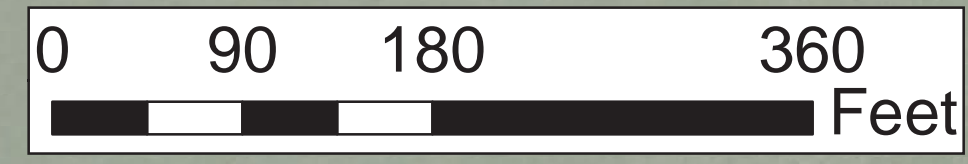

 engineers • surveyors • planners • scientists 1470 Sugarland Dr, Suite 1 Sheridan, WY 82801 Phone: (307) 672-9310 Fax: (307) 672-9311 COPYRIGHT © MORRISON-MAIERLE, INC., 2019	DRAWN BY: <u>_SKL_</u> CHK'D BY: <u>_TSB_</u> APPR. BY: <u>_RPB_</u> DATE: <u>_11/2019_</u>	VICINITY MAP - DRAFT For Meeting 11/15/19		PROJECT NO. WYDOT No. ARS3905 MMI No. 1806029
	TETON COUNTY	JACKSON, WY	TRIBAL TRAIL RD CONNECTOR	FIGURE NO. FIG. I-N14

W:\1806 WYDOT\029 WYDOT Tribal Trails\WYDOT_ARS3905\CADD\GIS\Exhibit_IN14.mxd; Plotted: 11/8/2019

Draft

COYOTE CANYON RD

Access Type Unchanged

HWY 22

Pathway Pedestrian Underpass

EMS At-grade access Closed to general traffic

INDIAN SPRINGS DR

Limited Access Gravel Road

TRIBAL TRAIL RD

- Edge of Lane Future
- CL Road Future
- Under Pass Future
- Edge of Lane Existing
- CL Road Existing
- Possible Pathway Locations
- Possible Pathway Locations - Underpass
- Existing Pathway Locations
- Pathway Underpass
- Pathway Underpass Structure
- Ownership
- Easement

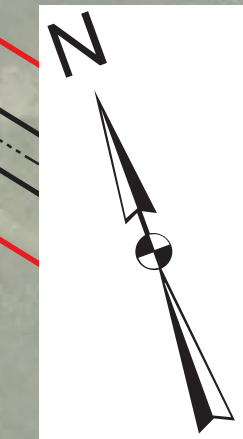
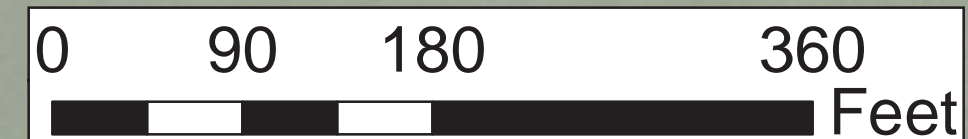

 engineers • surveyors • planners • scientists 1470 Sugarland Dr, Suite 1 Sheridan, WY 82801 Phone: (307) 672-9310 Fax: (307) 672-9311 COPYRIGHT © MORRISON-MAIERLE, INC., 2019	DRAWN BY: <u>SKL</u> CHK'D BY: <u>TSB</u> APPR. BY: <u>RPB</u> DATE: <u>11/2019</u>	VICINITY MAP - DRAFT For Meeting 11/15/19		PROJECT NO. WYDOT No. ARS3905 MMI No. 1806029
	TETON COUNTY	JACKSON, WY	TRIBAL TRAIL RD CONNECTOR	FIGURE NO. FIG. I-N15

W:\1806 WYDOT\029 WYDOT Tribal Trails\WYDOT_ARS3905\CADD\GIS\Exhibit_IN16.mxd; Plotted: 11/13/2019

COYOTE CANYON RD

Access Type Unchanged

Raised Island Right Turn Only Sign

HWY 22

Pathway Pedestrian Underpass

At-grade Right On Right Off Only

INDIAN SPRINGS DR

TRIBAL TRAIL RD

- Edge of Lane Future
- - - - CL Road Future
- Under Pass Future
- Edge of Lane Existing
- - - - CL Road Existing
- Possible Pathway Locations
- Possible Pathway Locations - Underpass
- Existing Pathway Locations
- Pathway Underpass
- Pathway Underpass Structure
- Ownership
- - - - Easement

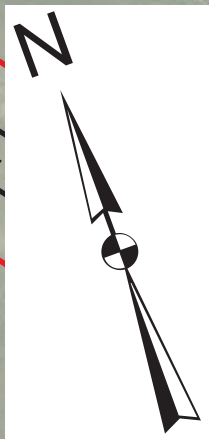
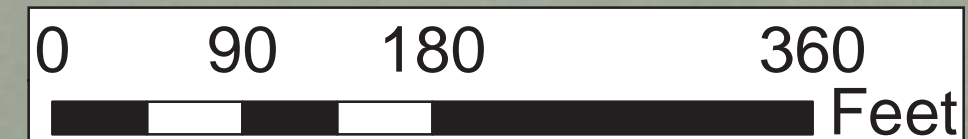

Morrison Maierle
engineers • surveyors • planners • scientists

1470 Sugarland Dr, Suite 1
Sheridan, WY 82801
Phone: (307) 672-9310
Fax: (307) 672-9311
COPYRIGHT © MORRISON-MAIERLE, INC., 2019

DRAWN BY: SKL
CHK'D BY: TSB
APPR. BY: RPB
DATE: 11/2019

VICINITY MAP - DRAFT For Meeting 11/15/19

TETON COUNTY JACKSON, WY

TRIBAL TRAIL RD CONNECTOR

PROJECT NO.
WYDOT No. ARS3905
MMI No. 1806029

FIGURE NO.
FIG. I-N16

W:\1806 WYDOT\029 WYDOT Tribal Trails\WYDOT_ARS3905\CADD\GIS\Exhibit_IN15.mxd; Plotted: 11/14/2019